

- | | |
|----------------------------------|------------------------------|
| (D) Montageanleitung | (FR) Notice de montage |
| (NL) Handleiding voor de montage | (CZ) Montážní návod |
| (HU) Szerelési útmutató | (TR) Montaj talimatı |
| (GB) Assembly instructions | (IT) Istruzioni di montaggio |
| (PL) Instrukcja montażu | (SK) Návod na montáž |
| (RO) Instrucțiuni de montaj | (RU) Инструкция по монтажу |

Service • Assistenza • Dienstverlening • Serwis
 Servis • Szerviz • Сервисная служба

Name • Nom • Nome • Naam •
 Nazwa • Jméno • Názov • Név •
 Denumire • Ísim • Название

Nr. • No. • N° • Номер • Č • Sz

Typ • Type • Tip • Típus • Тип •
 Тип

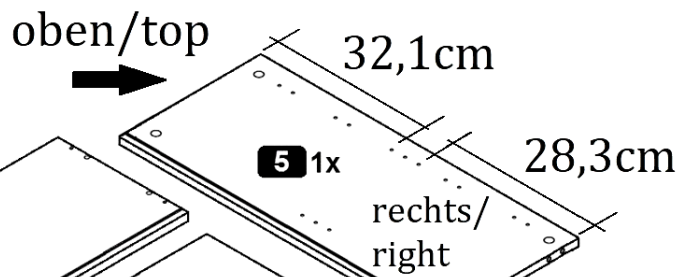
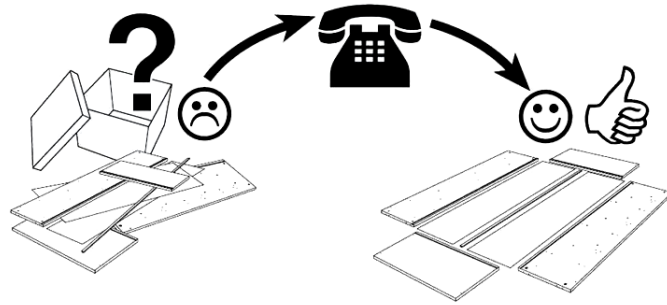
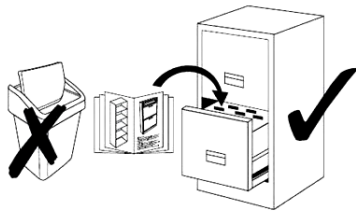

1	1x	ca. 922 x 350 mm
2	1x	ca. 903 x 680 mm
3	1x	ca. 922 x 330 mm
4	1x	ca. 668 x 330 mm
5	1x	ca. 668 x 330 mm
6	1x	ca. 668 x 315 mm
7	2x	ca. 459 x 338 mm
8	2x	ca. 459 x 338 mm
9	2x	ca. 437 x 300 mm

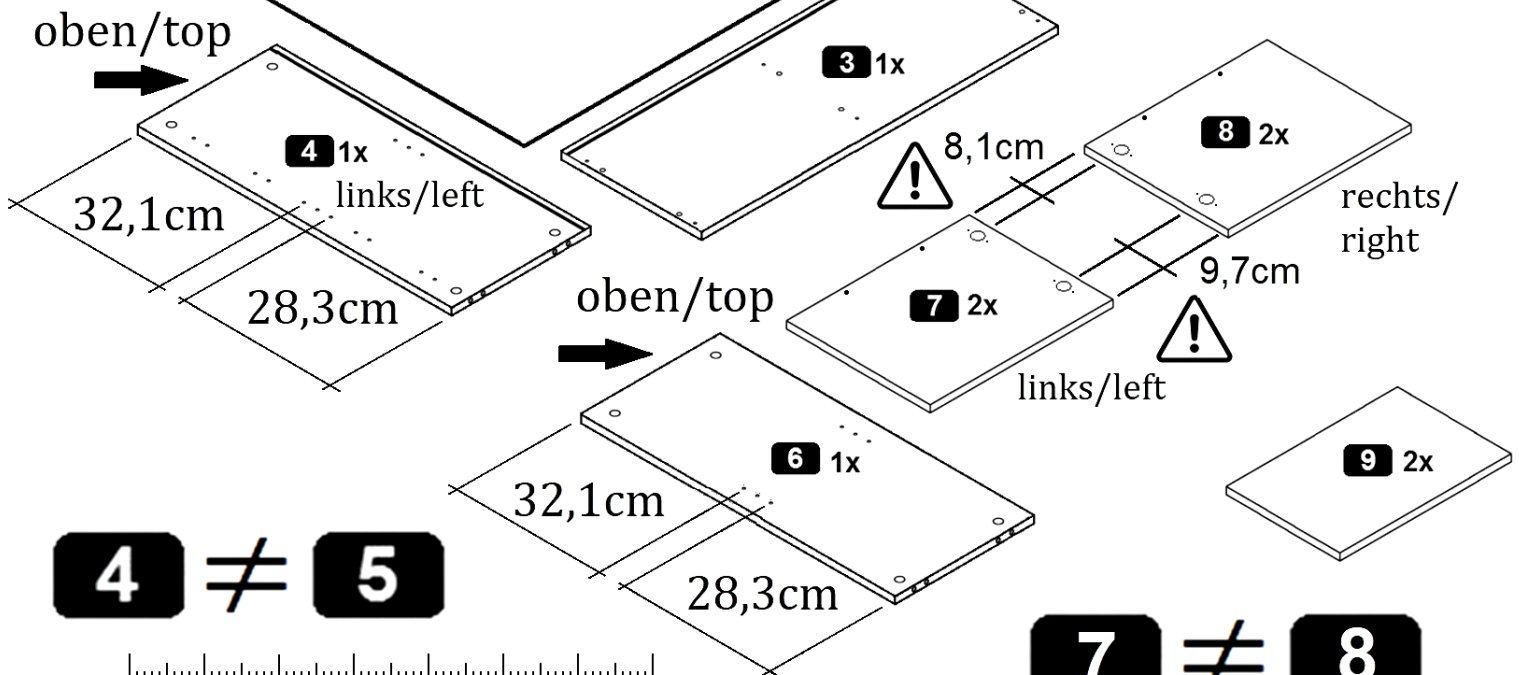

4 ≠ **5**

7 ≠ **8**



A 8,0 x 30 mm 12x	B 12x	C 12x	D 4x	E 3,5 x 13 mm 8x	F 5x	G 4,0 x 20 mm 5x
H Ø35 Kr.0 3,5x13 mm 8x	I h=2 8x	J 8x	K 2,7 x 20 mm 6x			

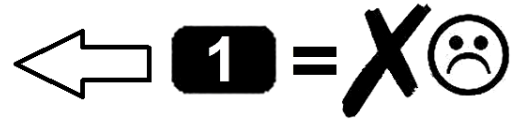
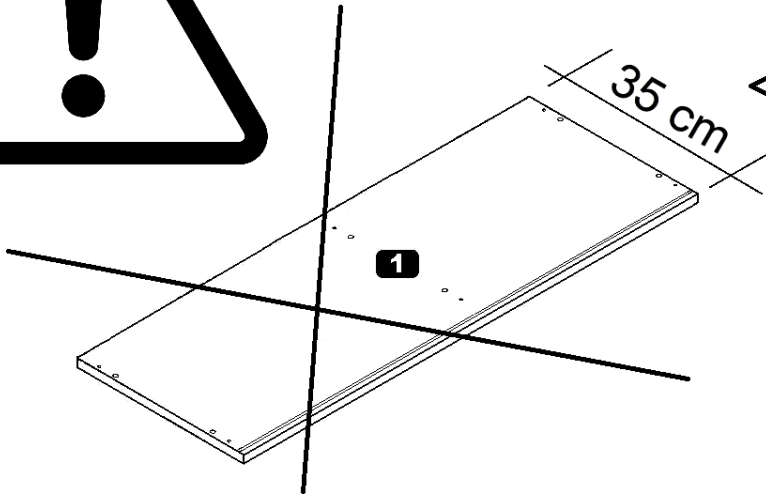
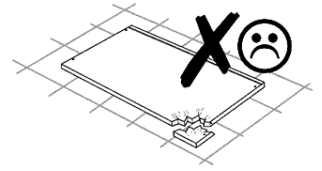
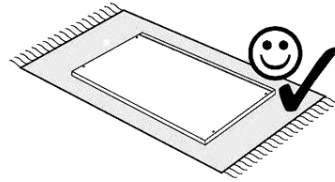

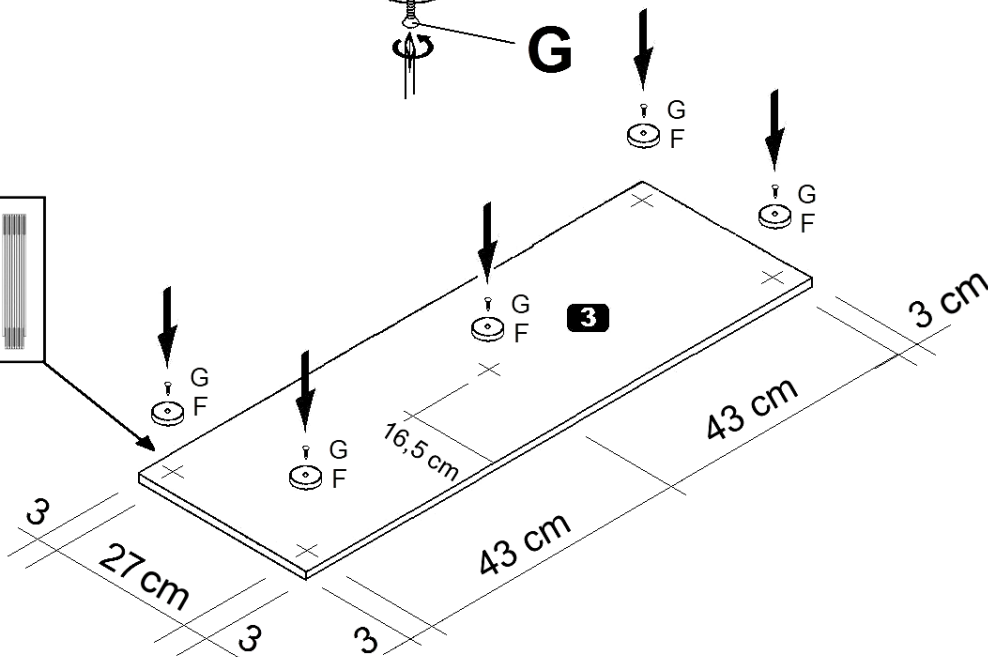
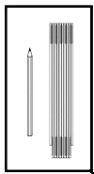
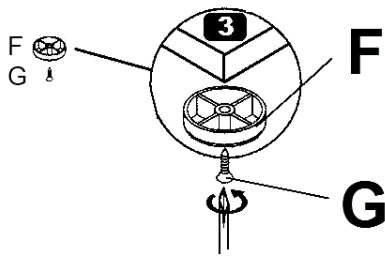
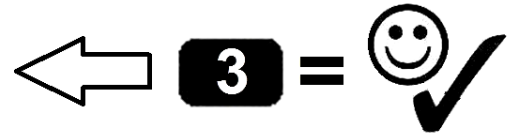
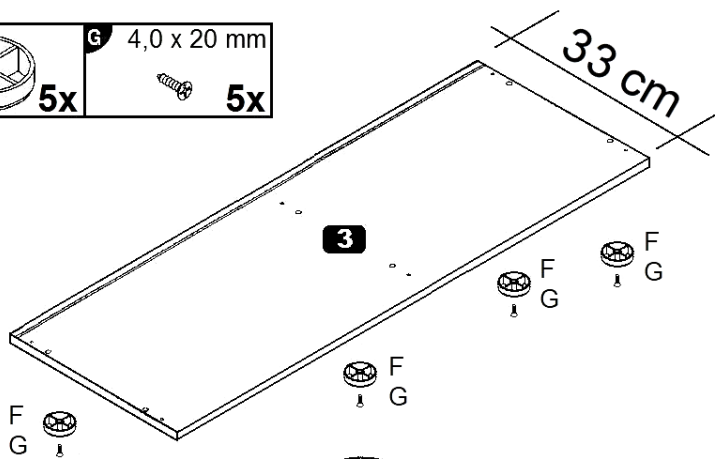
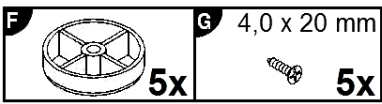

1

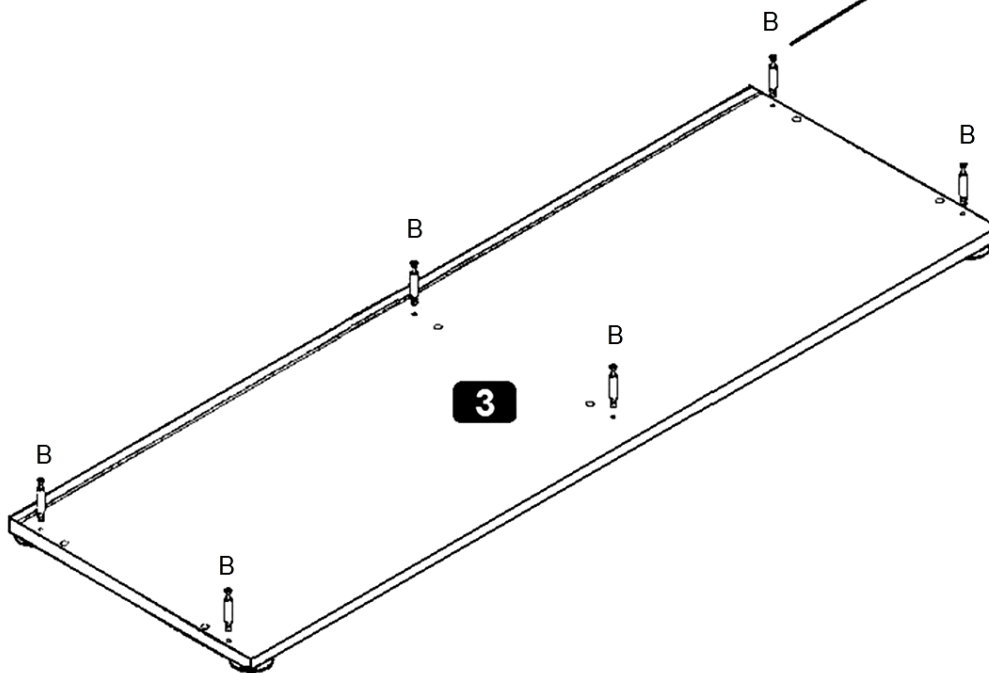
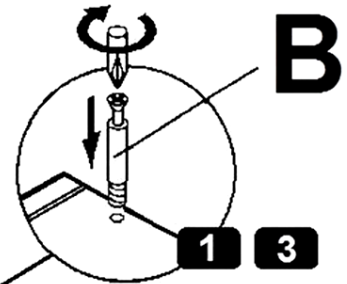
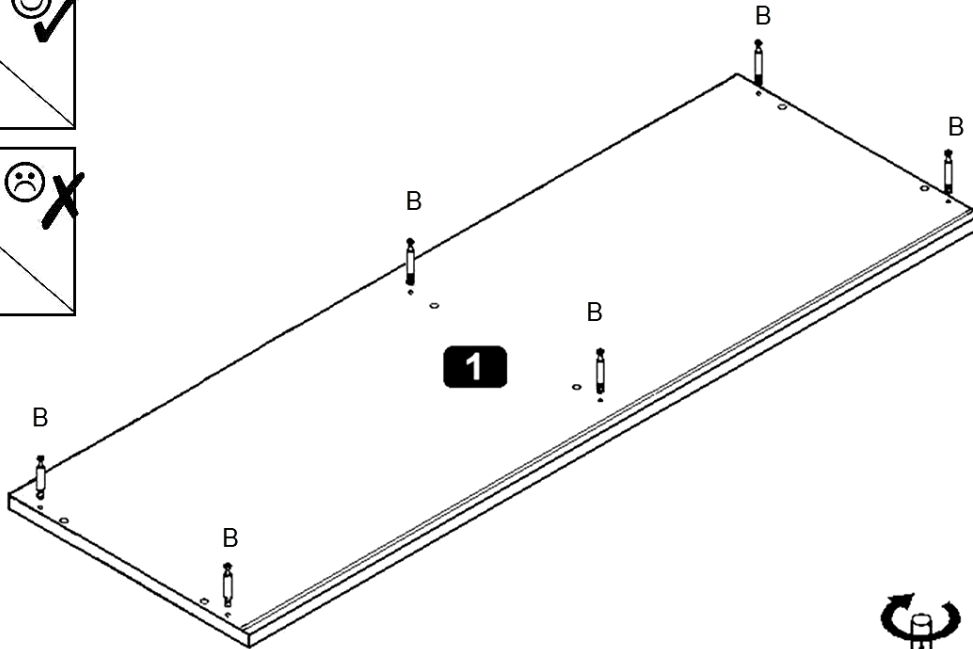
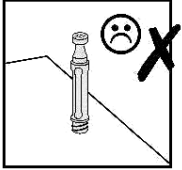
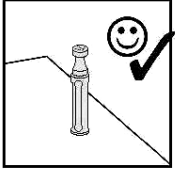
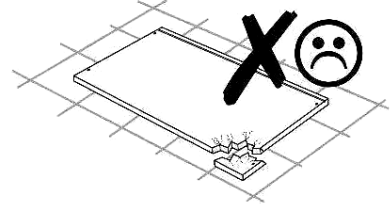
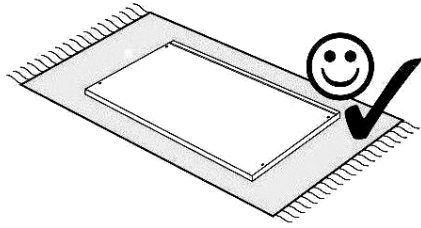
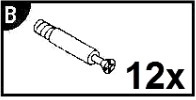

2

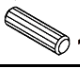

3

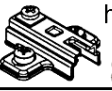
A 8,0 x 30 mm  12x	C  12x	 h=2 8x
---------------------------------------------------------------------------------------------------------------	---------------------------------------------------------------------------------------------------	---------------------------------------------------------------------------------------------

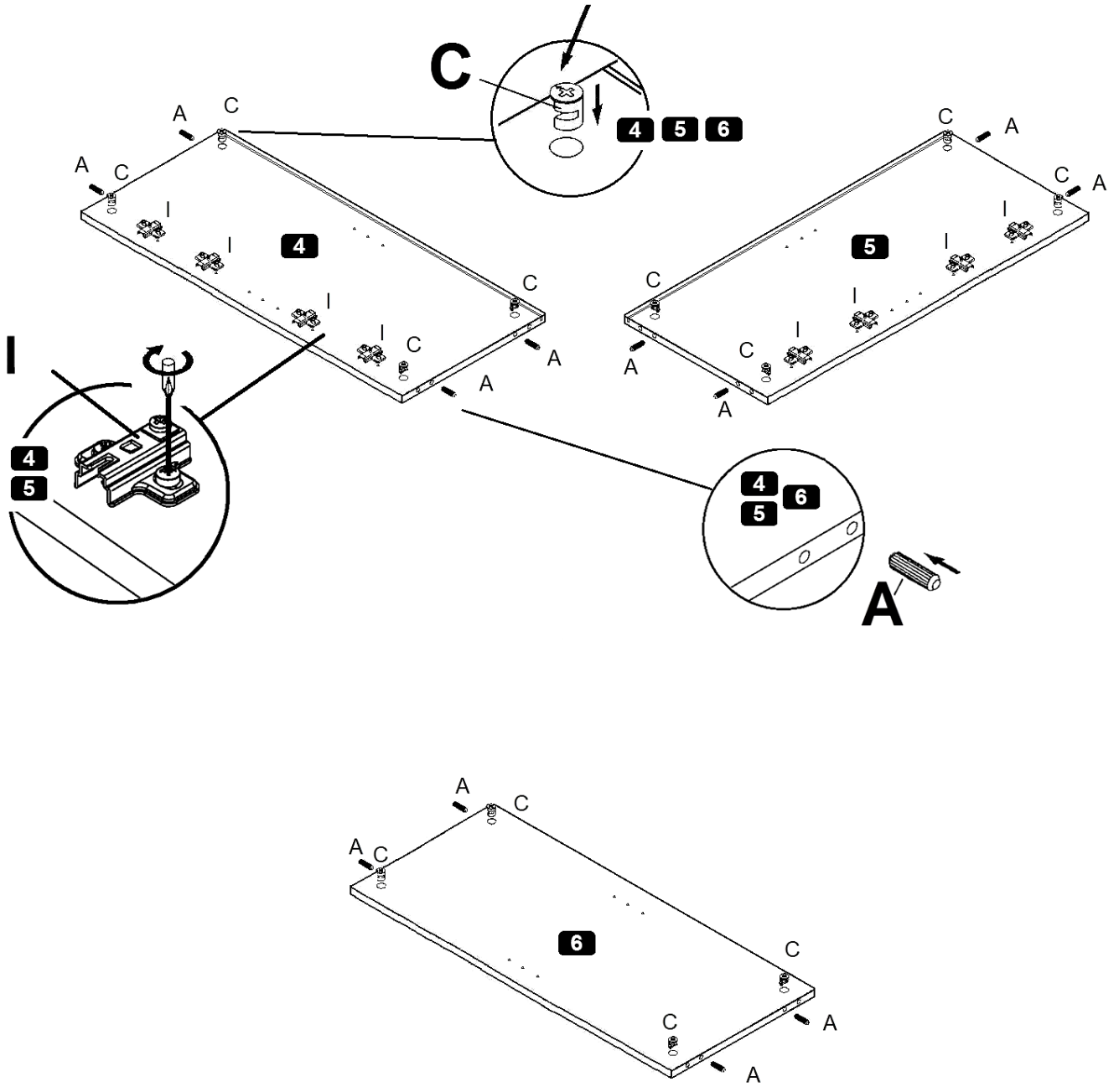
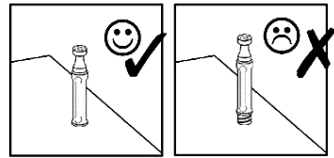

4

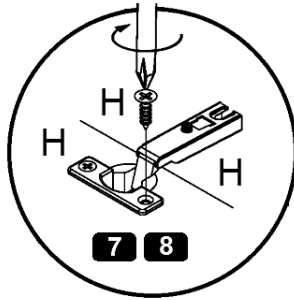
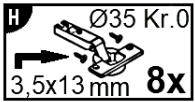

7 ≠ 8

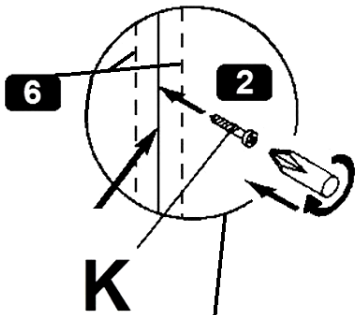
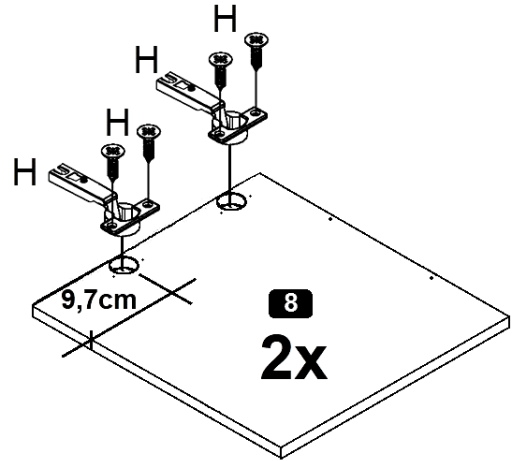
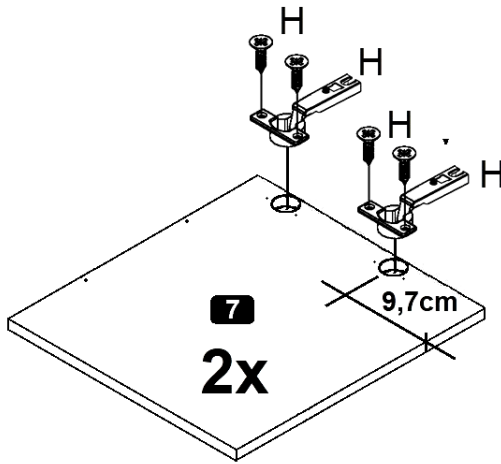

4 ≠ 5

5

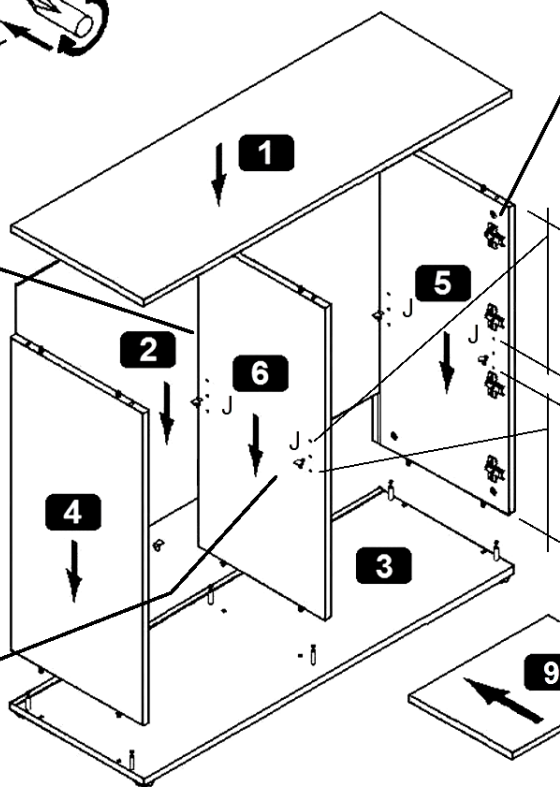
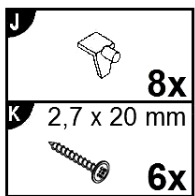

32,1cm

28,3cm

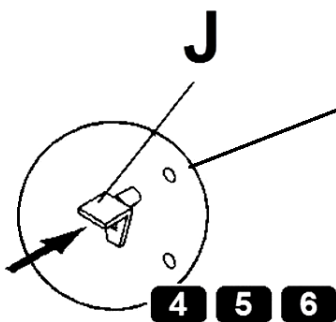

4 = links / left

5 = rechts / right

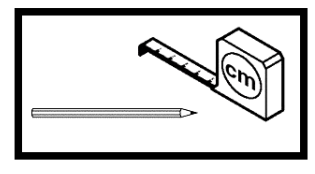

6

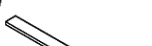
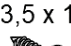
- D** 4x 
- E** 3,5 x 13 mm 8x 

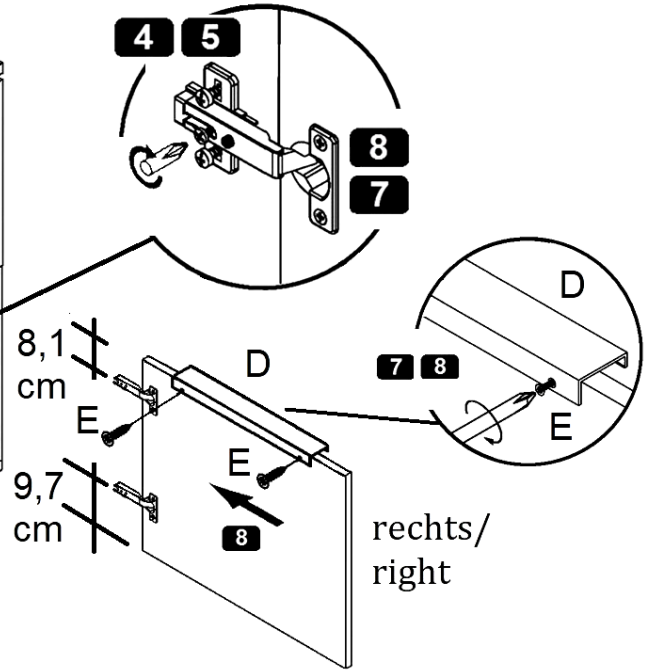
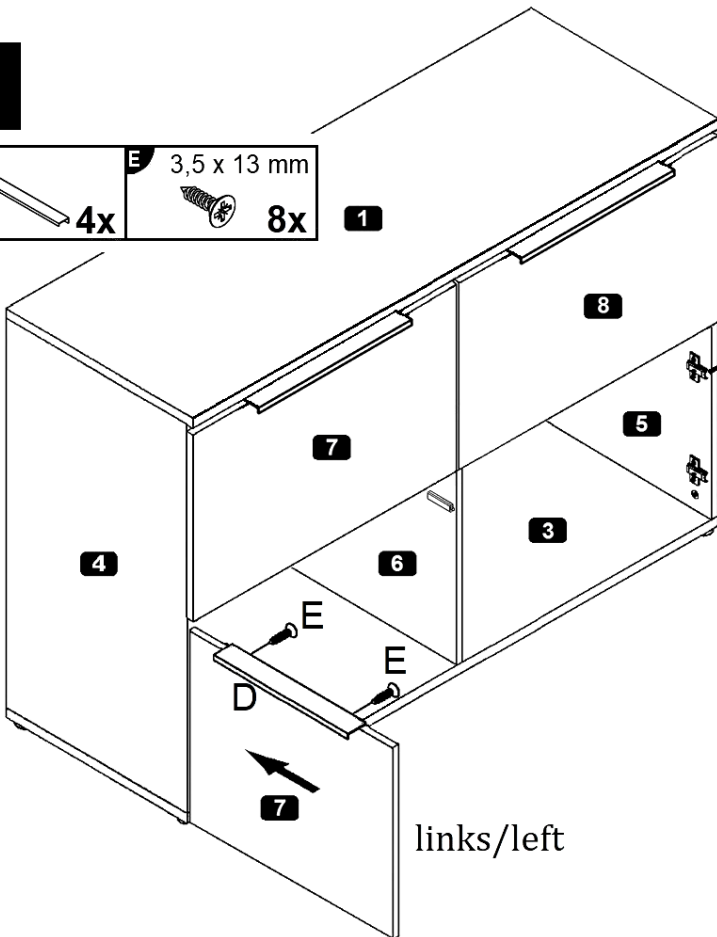

8 / 8

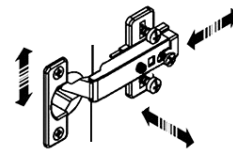

Ansicht von unten // bottom view

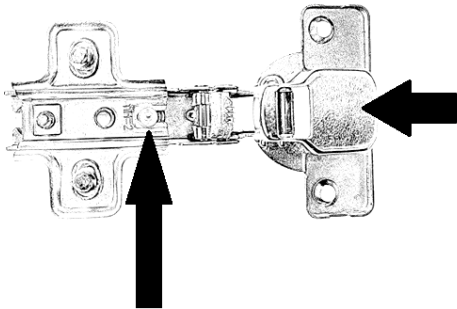

- D** Bitte in Schraubenführung stecken. Eventuell Verstellerschraube leicht herausdrehen.
- GB** Please put in screw guide. If necessary, unscrew the adjusting screw slightly.

D Türen einstellen
(Scharniere justieren)

GB Adjusting the doors
(adjusting the hinges)

FR Régler les portes
(ajuster les charnières)

IT Sistemare le porte
(regolare le cerniere)

NL Deuren instellen
(scharnieren afstellen)

PL Nastawić drzwi
(wyregulować zawiasy)

CZ Vyrovnajte dvířka
(seřid'te závěsy)

RO Nastavenie dverí
(nastavenie závesov)

HU Állítsa be az ajtókat
(állítsa be a zsanérokot)

SK Reglare uši
(ajustare balamale)

TR Kapıların ayarlanması
(menteşelerin seviye ayarı)

RU Регулировка дверей
(регулировка шарнира)

7

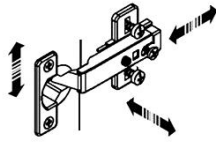

(D) Türen einstellen
(Scharniere justieren)

(GB) Adjusting the doors
(adjusting the hinges)

(FR) Régler les portes
(ajuster les charnières)

(IT) Sistemare le porte
(regolare le cerniere)

(NL) Deuren instellen
(scharnieren afstellen)

(PL) Nastawić drzwi
(wyregulować zawiasy)

(CZ) Vyrovnajte dvířka
(seřid'te závěsy)

(RO) Nastavenie dverí
(nastavenie závesov)

(HU) Állítsa be az ajtókat
(állítsa be a zsanérokot)

(SK) Reglare uši
(ajustare balamale)

(TR) Kapıların ayarlanması
(menteşelerin seviye ayarı)

(RU) Регулировка дверей
(регулировка шарнира)

